

# 2024 - 2025 Housing Guide For International Students



To apply for on-campus housing, visit: [msubillings.edu/reslife](https://msubillings.edu/reslife)



**MONTANA**  
STATE UNIVERSITY  
**BILLINGS**





**We are very excited you have chosen to attend MSU Billings. We strongly encourage all students to consider living on campus. It's a great way to get connected and make global friends.**

If you have any questions, please contact the Office of Housing & Residence Life Monday-Friday between 8 a.m. and 5 p.m. United States Mountain Standard Time or send us an e-mail.

**(001) 406-657-2333 • [housing@msubillings.edu](mailto:housing@msubillings.edu)**

## **CONVENIENCE**

Living on campus will put you in the center of student life and academics. Trust us, it's an experience you won't want to miss. Your time and energy should go towards your school work and extracurricular activities, not towards commuting, monthly bills, and grocery shopping. Living in the residence halls isn't just a place to stay, but it is your all access pass to the resources you'll need to succeed.



# THE ON CAMPUS EXPERIENCE

## **Wi-Fi Service**

Hard wired and wireless high speed internet service in each room along with the common areas on the floors and the main lobby.

## **Computer Lab**

Each residence hall has a computer lab with free printing.

## **Laundry**

Use your U-Card or quarters to use washing machines and dryers located on each floor.

## **Lounge Area**

Each floor has a lounge area with couches, chairs, a table, outdoor balcony, and a television with cable.

## **Kitchenette**

Feel like cooking? Each floor has a kitchen including a sink, microwave, stove, and oven for meal prepping.

## **Bath and Shower**

A full restroom and shower facility with private stalls placed on each wing of every floor.

## **Adjustable Bed**

Rooms are furnished with an adjustable bed that lifts 33¾ inches off the ground for prime storage space.

## **Ice Machines**

Ice machines are available in the main lobbies of each hall.

## **Parking**

Students need to purchase a parking pass if they have a vehicle they are parking on campus. We have designated parking with easy access to the residence halls.

## **Housing During Breaks**

Housing during the winter and summer breaks is available to students. Though residence halls officially close during those times, students can stay for a fee. The Residence Halls remain open during Thanksgiving and Spring Breaks at no additional costs. Dining Services has limited options during all breaks.

## **Entertainment**

MSUB students pay a fee each semester which gives them access to student activities. Student activities and events often include concerts, comedians, live entertainment, sporting events, and art exhibits.

## **Employment**

There are several departments on campus looking for amazing students to join their team as student employees. Billings is a large community full of economic opportunities for part-time work, internships, and volunteer experiences.

## **Student Organizations**

We have a wide range of student organizations and clubs which include academics, arts, supportive services, student government, culture & religion, recreation, and more.



## **ATHLETICS**

Cheer on your fellow Yellowjackets in one of the 17 NCAA Division II sports teams. We have the most sports teams in the state!

## **STUDENT WELLNESS**

We're here to help students thrive and succeed! We provide medical care, mental health counseling, and a wellness program to help you make the most of your time at MSUB. Students can utilize the Health Service just across from Petro Residence Hall Lobby and at City College in the Tech Building.

## **TUTORING AND MENTORING**

Located in the Student Union Building and at City College in the Tech Building, you don't have to go outside to take advantage of our Academic Support Center. Get tutoring assistance to get you through a challenging course, take advantage of other workshops and resources, or just settle in to study.

## **HONORS**

Our honors program provides intellectually stimulating classes and career building opportunities for those who apply. Honors Students receive special advising and mentorship throughout their education at MSU Billings.

## **RESIDENCE HALL ASSOCIATION (RHA)**

RHA's main focus is social and educational programming for residents, providing ample opportunities for interaction and involvement.

# **Apply Now!**

- Apply for Housing online at: [www.msubillings.edu/reslife](http://www.msubillings.edu/reslife)
- Select "Housing Portal - Apply Now"
- Log in to the Housing Portal using the information provided in your MSUB Acceptance email
- Apply, select a roommate and room, change your housing options, and receive updates through this Housing Portal

For questions concerning your login information or application process, call the Housing Office, Monday-Friday from 8:00am-5:00pm at 406-657-2333 or via email at: [housing@msubillings.edu](mailto:housing@msubillings.edu).





## **Here is who is required to live on campus:**

Traditional age students less than 3 years out of high school and under 30 credits at the start of the fall semester (this includes City College students).

## **Students are automatically exempt from housing if they are under 30 credits and meet the following criteria:**

- Students Over 21 Years of Age: As verified through MSUB student information systems
- Military Veteran: As verified through MSUB Student information systems
- Enrolled in 5 or fewer credits: As verified through MSUB Student Information systems
- Transfer Student: As verified through MSUB Student Information systems
- Online Student: As verified through MSUB student information systems
- Non-Degree Seeking Student: As verified through MSUB Student information systems

## **Contact the Housing Office if you believe you meet one of the following exemptions to the live on requirement:**

- Living with Immediate Family (Legal Guardian, Parent, or Grandparent) within Yellowstone County
- Married
- Physical custody of a dependent child
- Financial Hardship
- Medical Related Condition
- Documented Disability
- Unusual Circumstances

## **Student Health Insurance**

All Montana State University Billings students enrolled in seven or more credits are required to have some form of health insurance. A student health insurance policy is available to MSU Billings students. Before registering, students will be asked to elect or waive the student health insurance. All students are eligible for health insurance if enrolled for 7 or more credits. The waiver or election process must be completed by the 15th day of fall and spring semesters. The premiums are paid on a semester basis along with tuition and fees. Those students taking the insurance for spring semester will also be covered during the summer semester, even if they are not enrolled in summer classes.

Policy brochures are located at Business Services

Full information about the Student Health Insurance plan provided by The Montana University Insurance Consortium is available at [university.bcsmt.com](http://university.bcsmt.com).

If you have any questions about enrolling in coverage for other family members, such as spouse or children, you may contact Business Services, 406-657-2140.





**Petro Hall (6 floors)**

**Student Union**

Academic Support Center  
 Center for Engagement  
 Game Room  
 Housing & Residence Life office  
 Stinger's Bistro  
 Student Senate

**Rimrock Hall (4 floors)**

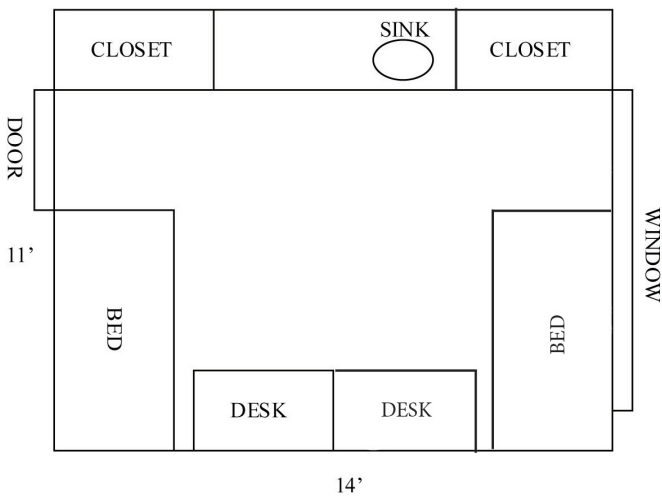
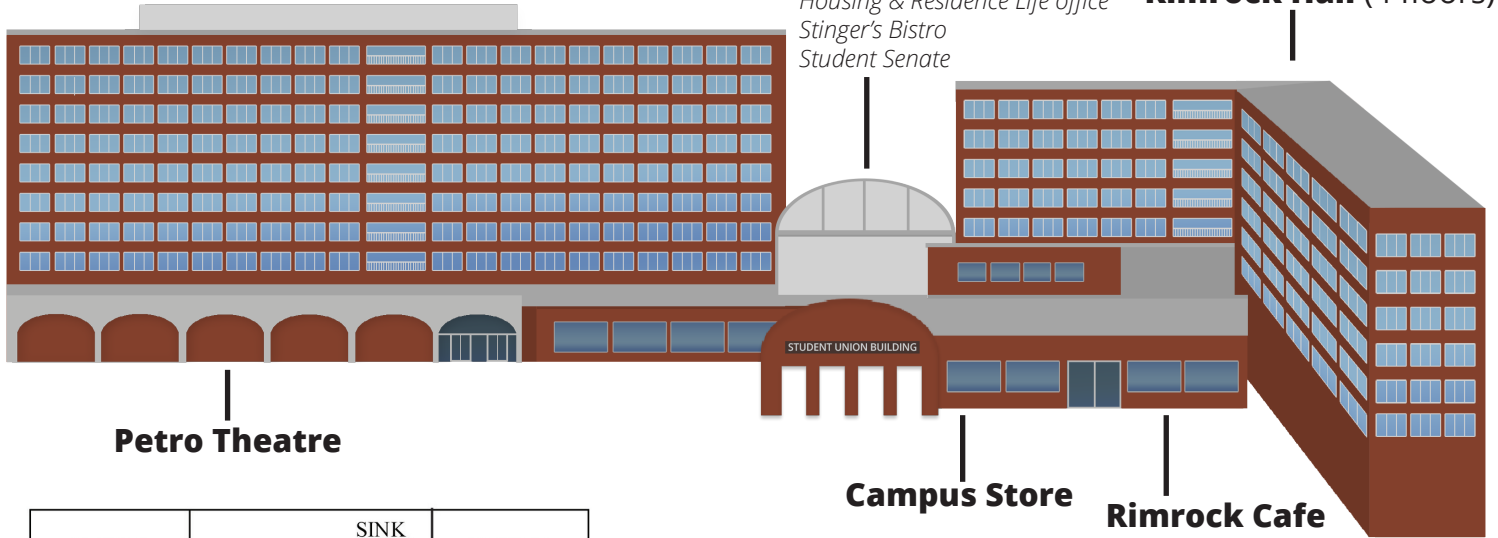

**How much does living on campus cost?**

Semester Rates for 2024 - 2025

Double room - \$2602 semester

Single room - \$3155 semester

Rimrock Hall and Petro Hall have very similar room styles that are 11 by 14 feet. Each room includes two desks, built in shelves, two closets, a sink with a counter and mirror, curtains, wireless & hard wired internet access, and two twin adjustable beds with bunking abilities. Petro has a dedicated workout space on the main floor. Rimrock and Petro hall have computer lab and printing access for students.





## Petro Hall



## Petro Hall (6 floors)

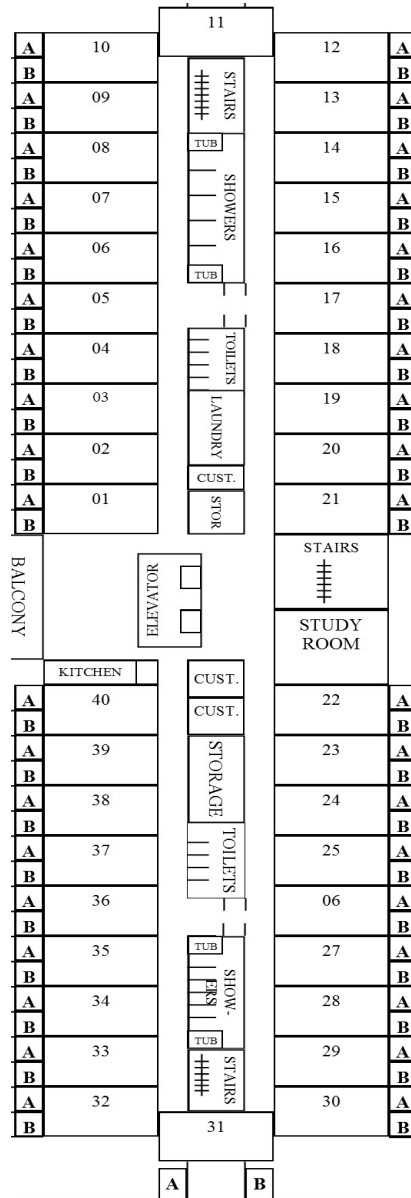

## Rimrock Hall (4 floors)

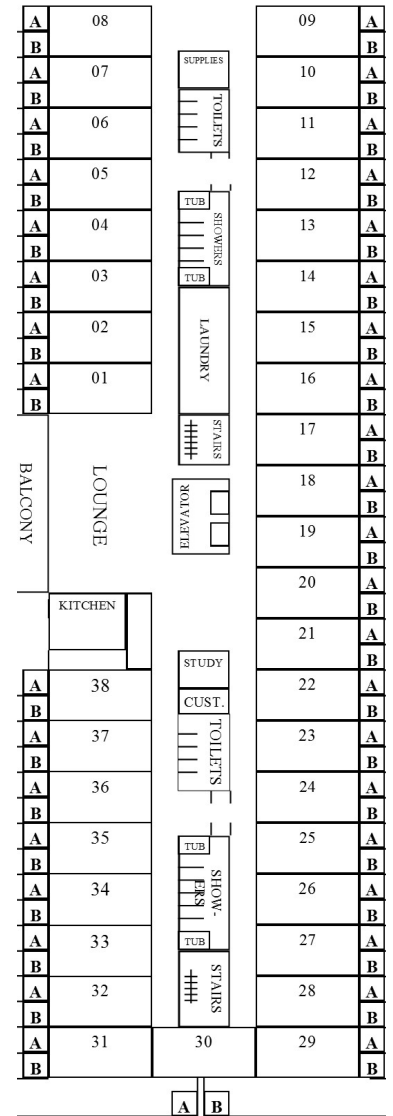

## Rimrock Hall



## Student Union Building



## MEAL PLANS

### COST PER SEMESTER 2024-2025

#### Stinger - \$2250

This plan provides 19 meals per week in our all-you-care-to-eat Rimrock Café plus \$50 in Dining Dollars.

#### Buzz - \$2250 Monday-Friday

This plan provides three meals per day, Monday through Friday in our all-you-care-to-eat Rimrock Café plus \$275 in Dining Dollars.

#### Hive - \$2100

This plan is a block meal plan, providing 160 meals per semester in our all-you-care-to-eat Rimrock Café plus \$300 in Dining Dollars.

#### Nest - \$2041

This plan is a block meal plan, providing 125 meals per semester in our all-you-care-to-eat Rimrock Café plus \$400 in Dining Dollars.

*Dining services works to support the needs of our international students and their meal preferences.*



# LIVING AND DINING

## What is a Block Meal Plan?

A type of meal plan that gives you a set number of meals to eat within a given semester. Students must use meals within the semester and meals will not carry over to the next semester.

## What is a Meals Per Week Plan?

A type of meal plan that provides a set number of meals within a week. Students must use the defined number of meals within the given week, and the meals will not carry over to another week. The Stinger and Buzz Monday-Friday meal plans are per week plans

## What are Dining Dollars?

Money put on your U-Card to use for coffee and other grab-and-go items from any MSU Billings dining location on the University and City College campus. Your dining dollar balance will carry over from the Fall to Spring semester, but needs to be used by the end of Spring semester. Dining dollars are a part of all of our residence halls meal plans.

## U-Card

Your U-Card is not only your university identification, but also your library card, and more. Deposit money on your card to use around campus for printing, purchasing gear at the Campus Store, buying food and coffee at any of the campus food service locations, and vending machines. *Students will learn how to add money to their U-Card at orientation.*

## City College Dining

At City College, dining is a-la-carte, and students can select from a variety of meal options. Students can still use a meal from their plan when they eat at City College, rather than using dining dollars or paying in cash.

## How do I know what meal plan is best for me?

Consider your current eating habits. Will you want three full meals per day, or will you want to grab a snack for some? Do you anticipate working in the evening? Dining Services is willing to provide a sack meal for students who might miss an evening meal. Just ask.

## Double and Single Rooms

Every room is built the same that means single rooms are the same size and include everything a double room does. Single rooms are assigned based on space and availability.

## Social & ResNet Fees

Every semester, students pay a \$15 Social Fee and a \$75 ResNet Fee. The \$15 Social Fee goes into the programming budget for planned events during the academic year in the residence halls. The \$75 ResNet fee goes to continued support, maintenance, and improvements for our technology and Wi-Fi service in the residence halls.





# Next Steps for New International students

- 1. Apply for housing at [msubillings.edu/reslife](http://msubillings.edu/reslife) and pay your \$125 application fee.**  
(Visa & Mastercard accepted. No American Express) Room assignments are available online starting in mid June. *\*We cannot reserve a room for students without their housing application and \$125 deposit.*  
[www.msubillings.edu/reslife](http://www.msubillings.edu/reslife)
- 2. Read your acceptance letter and welcome packet very carefully. It includes very important information.**
- 3. Make travel arrangements that have you arrive in Billings by the arrival deadline located on your acceptance letter. You are not guaranteed housing on campus prior to the arrival date specified by International Studies.**
- 4. Confirm with the International Studies Office your arrival time and date. Please scan and email your confirmation form to [ois@msubillings.edu](mailto:ois@msubillings.edu) at least two weeks before your departure from your home country.**
- 5. Attend New International Student Orientation. The dates for your orientation are located on your acceptance letter.**
- 6. Be prepared to pay your bill before classes start.**
- 7. Begin your new adventure at MSU Billings!**





# Frequently Called Numbers

- Admissions (001) 406-657-2888
- Advising (001) 406-657-2240
- Business Services (Student Accounts): (001) 406-657-2140
- University Police: (001) 406-657-2222 (emergency number)
- Campus Store (textbooks): (001) 406-657-2121
- Career Services: (001) 406-657-2168
- Cashier: (001) 406-657-1709
- Center for Engagement: (001) 406-657-2387
- Financial Aid: (001) 406-657-2188
- Housing & Residence Life: (001) 406-657-2333
- International Studies Office (001) 406-657-1705
- Library: (001) 406-657-2262
- Mailroom: (001) 406-657-2241
- Parking: (001) 406-657-2147
- Registrar: (001) 406-657-2158
- Student Health Services: (001) 406-657-2153



**For more information, contact the Office of Housing & Residence Life  
(406) 657-2333**

**[msubillings.edu/reslife](https://msubillings.edu/reslife)**

**[housing@msubillings.edu](mailto:housing@msubillings.edu)**

**Student Union Building, 225**

Montana State University Billings | 1500 University Drive | Billings, Montana 59101-0245



Montana State University Billings has a policy of nondiscrimination in employment practices and in admissions, access to and conduct of educational programs and activities pursuant to title VII of the Civil Rights Act, Title IX of the Education Amendments, Section 504 of the Rehabilitation Act, Executive Order 11246 as amended, Vietnam era and Disabled Veterans Act, as amended, and the Montana State Human Rights Act. Any person with disabilities concerned about accessibility and/or accommodation issues should contact Disability Support Services (406) 657-2283.

To access the annual campus crime report, please visit: [msubillings.edu/security](https://msubillings.edu/security)  
To access consumer information visit: [msubillings.edu/finaid/Consumer\\_Information.htm](https://msubillings.edu/finaid/Consumer_Information.htm)