



HOUSING &
RESIDENCE LIFE
MONTANA STATE UNIVERSITY BILLINGS

Student Life & Living On Campus

Apply Now to Live
On Campus!

msubillings.edu/reslife

Welcome

Students who live on campus enjoy a connected, secure, and supportive community that fosters academic success. It's convenient, affordable, and a place where lifelong friendships and memories are made. Residents can meet new people, attend programs, access campus jobs, enjoy dining options, and live close to classes, services, and recreation. On-campus housing is available to students from both University and City College campuses.



The Details

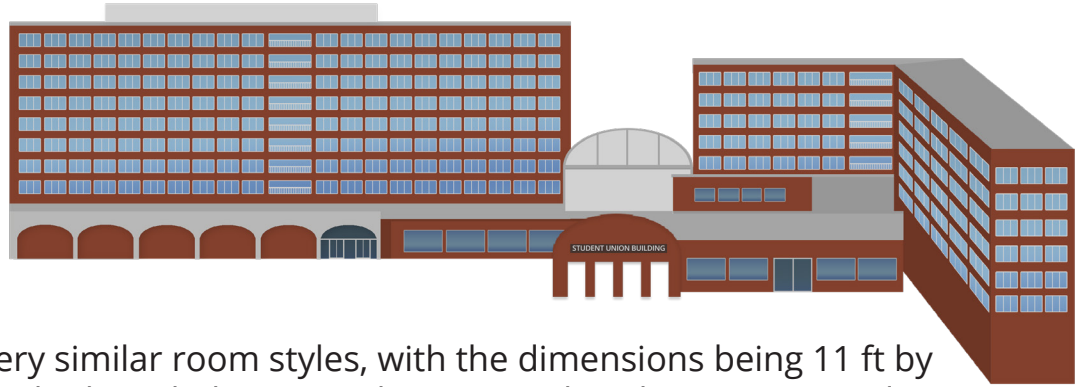

Rimrock Hall and Petro Hall have very similar room styles, with the dimensions being 11 ft by 14 ft. Each room includes two desks, built in shelves, two closets, a sink with a counter and mirror, blinds, wireless & hard-wired internet access, and two twin XL adjustable beds with bunking abilities. Petro has a dedicated workout space on the main floor.

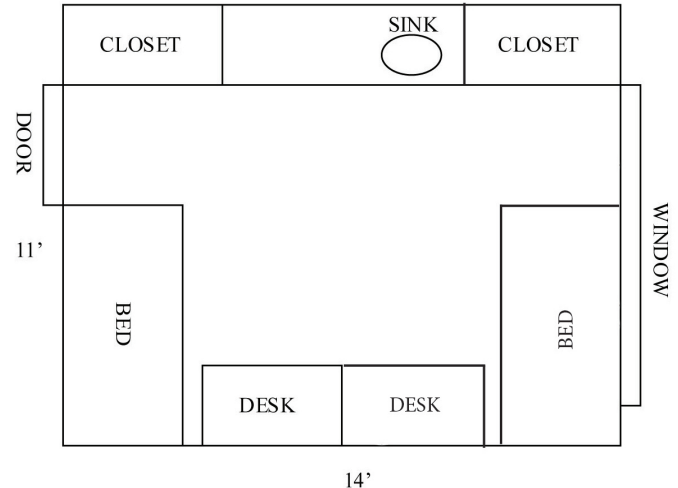

Apply to Live On Campus

Our online application is now open at:
www.msubillings.edu/reslife.

Here, you will apply for your room, select your room and fill out a roommate matching questionnaire which will assist in the roommate selection process.

*We can't wait to
welcome you to your
home sweet home!*

FALL SEMESTER MOVE-IN DATES

Halls Open: Sunday, August 31, 2025 at 9:00 AM

SPRING SEMESTER MOVE-IN DATES

Halls Open: Sunday, January 11, 2026 at 9:00 AM



Amenities

Wi-Fi Service

Hard wired (available upon request) and wireless high speed internet service in each room along with the common areas on the floors and the main lobby.

Computer Lab

Each residence hall has a computer lab with free printing and a dedicated space for studying.

Laundry

Laundry is free! Residents have access to washing machines and dryers located on each floor.

Lounge Area

Each floor has a lounge area with couches, chairs, a table, outdoor balcony, and Smart TV.

Kitchenette

Feel like cooking? Each floor has a kitchen including a sink, microwave, stove, and oven for meal prepping. Pots and pans will be available to check out at the front desk.

Bath and Shower

A full restroom and shower facility with private stalls placed on each wing of every floor.

Adjustable Bed

Rooms are furnished with an adjustable bed that lifts 33¾ inches off the ground for prime storage space.

Ice Machines

Ice machines available in the main lobbies of each hall.

Parking

Parking available to students with easy and quick access to each residence hall.



Living On Campus Advantage

- No large deposit upfront to guarantee room
- High Speed internet
- All Utilities (garbage / sewer / water / electricity / gas / internet)
- Custodians clean each floor daily
- Basic supplies on each floor (paper products / soap / cleaning supplies / etc.)
- Laundry Rooms on each floor with no-charge washers and dryers
- Kitchenette on each floor
- Common Spaces / Study Spaces on each floor and in each hall (Computer lab and Printer available for students living in the halls)
- Housing staff accessible to help students navigate their college experience (RAs on each floor / Hall Director in each building / Associate Dean / Support Staff)
- Police Department that patrols 24/7, 365 days a year
- Facilities Department that is staffed with full-time plumbers / electricians / carpenters / etc. to take care of all campus needs. Students never get a bill to get anything fixed in their rooms (unless it was intentional behavior that caused the need for repairs), and repairs are done in a timely manner.
- Full-Service dining team and options for all residents to stay nourished: Rimrock Café, Stingers Bistro, Sub Connections



Housing during the winter and summer breaks is available to students. Though residence halls officially close during those times, students can stay for a fee. The Residence Halls remain open during Thanksgiving and Spring Breaks at no additional costs. Dining Services has limited options and hours during all breaks.

MSUB students receive free entry into our student activities and events including concerts, comedians, and other live entertainment, sporting events, and art exhibits.

There are several departments on campus looking for amazing students to join their team as student employees. Billings is a large community full of economic opportunities for part-time work, internships, and volunteer experiences.

We have a wide range of student organizations and clubs which include academics, arts, supportive services, student government, culture & religion, recreation, and more.

Cost Estimate for On Campus Living

Semester Rates for 2025 - 2026

Double Room

\$2515 / Semester

Social Fee

\$20.00

Resnet Technology Fee

\$75.00

Total

\$2610.00

\$580.00 per month

Single Room

\$3069 / Semester

Social Fee

\$20.00

Resnet Technology Fee

\$75.00

Total

\$3164.00

\$703.11 per month

Rates subject to change. For most up-to-date information please go to: msubillings.edu/reslife

Meal Plans

COST PER SEMESTER 2025-2026 (Rates subject to change)

Stinger - \$2253

This plan provides 19 meals per week in our all-you-care-to-eat Rimrock Café plus \$50 in Dining Dollars.

Buzz - \$2253 *Monday-Friday*

This plan provides three meals per day, Monday through Friday in our all-you-care-to-eat Rimrock Café plus \$275 in Dining Dollars.

Hive - \$2102

This plan is a block meal plan, providing 160 meals per semester in our all-you-care-to-eat Rimrock Café plus \$300 in Dining Dollars.

Nest - \$2044

This plan is a block meal plan, providing 125 meals per semester in our all-you-care-to-eat Rimrock Café plus \$400 in Dining Dollars.

Cost Estimates for Off Campus Living

(1 and 2 bedroom apartments and houses)

Rent	\$850 - \$1350/mo
Security Deposit	\$350 - \$1350
Hook-ups	\$25 - \$65
Utility Deposit	\$150 plus
Phone Bill	\$90/mo
Utilities	\$75 - \$150/mo
Laundry	\$50/mo
Travel to Campus	\$60/mo
Cable TV	\$80/mo
High Speed Internet	\$60/mo
TOTAL	\$1,720 - \$3,405/mo

Logatty Program

The Longer You Stay, The More You Save!

2nd Year On Campus - 5% Off Residence Hall Room Cost

3rd Year On Campus - 7.5% Off Residence Hall Room Cost

4th Year On Campus - 10% Off Residence Hall Room Cost

Total of 22.5% Savings Across 4 Years!

Extended Stay Program

Need a room in the residence halls for a night, a week or longer? Extended Stay offers a new flexible option if rooms are available, especially for commuter students during the winter months. Spend a night (or more as you wish) in the residence halls. (Note: A meal plan is not required for this option.)

- Daily rate - \$40
- Weekly rate - \$250



Apply Today!



Additional Services



BE A LEADER

Leadership opportunities include running for an elected position within ASMSUB (student government), attending leadership seminars and workshops, joining a student club with opportunities to take on a student leadership role and much more...

STUDENT WELLNESS

We're here to help students thrive and succeed! We provide medical care, mental health counseling, violence prevention, advocacy services and a wellness program to help you make the most of your time at MSUB. Students can utilize the Health Service just across from Petro Residence Hall Lobby.

TUTORING AND MENTORING

Located in the Student Union Building, you don't have to go outside to take advantage of our Academic Support Center. Get tutoring assistance to get you through a challenging course, take advantage of other workshops and resources, or just settle in to study.

HONORS

Our honors program provides intellectually stimulating classes and career building opportunities for those who apply. Honors Students receive special advising and mentorship throughout their education at MSU Billings.

RESIDENCE HALL ASSOCIATION (RHA)

RHA's main focus is social and educational programming for residents, providing ample opportunities for interaction and involvement.

Campus Safety & Security

MSUB strives to provide the most secure environment possible for students, faculty, staff, and visitors. Keeping all of our resident and non-resident students safe is our priority. www.msubillings.edu/future/asfsr/index.htm

Access Security

Residence Hall exterior doors are equipped with electronic access control, which requires a finger scan of their index finger to gain access. Only residents and appropriate staff can enter residence halls with this technology. Bedrooms doors are secured by traditional keyed locks.

Fire Protection

The rooms and common areas in each hall are equipped with protection systems including hard-wired fire alarms and state-of-the-art fire sprinklers.

24/7 Police & Surveillance

The University Police Department is a fully empowered law enforcement agency. The main objective of this department is to ensure the safety, peace, and tranquility of the academic community and our residence halls. Police officers patrol the campus 24 hours a day. Closed circuit surveillance cameras, monitored by the police department and housing staff, are located at every residence hall entrance/exit door and throughout campus. For more information about the University Police Department, please visit the University Police Department. www.msubillings.edu/police/default.htm

Residence Hall Staff

Each floor is staffed with at least one Resident Assistant (RA) who works closely with our campus police to ensure students' safety. All of our RAs monitor the security of our residence halls. The RAs are trained on how to respond during an emergency situation if needed.

Security Outside the Halls

Ample exterior lighting is located outside each building, in the residence hall parking lots, and along all of our popular walkways. University Police are regularly patrolling and also provide safe walks for students who request them.

Emergency Notification

Timely, reliable communications are critical in emergency situations. The Emergency Notification System allows MSUB to notify students, faculty, and staff through voice and text messages during a campus emergency. Messages can be sent cell phones and e-mail addresses. The system has the capability of reaching all faculty, students, and staff within minutes. Parents are also encouraged to enroll in the safety alert program. www.msubillings.edu/ens

We're here to help!

Just as we work with you, we partner with students and other departments to create welcoming, vibrant, and inclusive residence hall communities. Students do more than simply live in our halls; they take the opportunity to learn, engage, and grow as they develop as citizens and leaders. We are a Yellowjacket Family!



housing@msubillings.edu
(406) 657-2333





Housing & Residence Life
1500 University Drive
Billings, MT 59101-0298
640021

Non-Profit Org.
U.S. Postage

PAID

Permit No. 483
Billings, Montana