

2024-2025

HOUSING & RESIDENCE LIFE GUIDE



To apply for on-campus housing, visit:
msubillings.edu/reslife





WELCOME

Students who live on campus experience our connected, secure, and supportive community. Not only is it convenient and affordable, but it is proven that students who live on campus are more successful academically. For many students, this is where lifelong friendships and memories are made. Students who live on campus meet new people, attend social and educational programs, engage in campus employment opportunities, access convenient dining options, and live in close proximity to classes, campus services, and recreational opportunities.

Our online application is now open at www.msubillings.edu/reslife. Here, you will apply for your room and fill out a roommate matching questionnaire and choose your own room & roommate. **First time Freshmen students under age 21 are required to live on campus for their first year of school.**

CONVENIENCE

Living on campus will put you in the center of student life and academics. Trust us, it's an experience you won't want to miss. Your time and energy should go towards your school work and extracurricular activities, not towards commuting, monthly bills, and grocery shopping. Living in the residence halls isn't just a place to stay, but it is your all access pass to the resources you'll need to succeed.

FALL SEMESTER MOVE-IN DATES

Halls Open: Sunday, September 1, 2024 at 9:00 AM

Halls Close: Friday, December 13, 2024 at 12:00 PM

SPRING SEMESTER MOVE-IN DATES

Halls Open: Sunday, January 12, 2025 at 9:00 AM

Halls Close: Friday, May 2, 2025 at 12:00 PM

THE ON CAMPUS EXPERIENCE

Wi-Fi Service

Hard wired and wireless high speed internet service in each room along with the common areas on the floors and the main lobby.

Computer Lab

Each residence hall has a computer lab with free printing.

Laundry

Use your U-Card or quarters to use washing machines and dryers located on each floor.

Lounge Area

Each floor has a lounge area with couches, chairs, a table, outdoor balcony, and a television with cable.

Kitchenette

Feel like cooking? Each floor has a kitchen including a sink, microwave, stove, and oven for meal prepping.

Bath and Shower

A full restroom and shower facility with private stalls placed on each wing of every floor.

Adjustable Bed

Rooms are furnished with an adjustable bed that lifts 33³/₄ inches off the ground for prime storage space.

Ice Machines

Ice machines are available in the main lobbies of each hall.

Parking

Students need to purchase a parking pass if they have a vehicle they are parking on campus. We have designated parking with easy access to the residence halls.

Housing During Breaks

Housing during the winter and summer breaks is available to students. Though residence halls officially close during those times, students can stay for a fee. The Residence Halls remain open during Thanksgiving and Spring Breaks at no additional costs. Dining Services has limited options during all breaks.

Entertainment

MSUB students pay a fee each semester which gives them access to student activities. Student activities and events often include concerts, comedians, live entertainment, sporting events, and art exhibits.

Employment

There are several departments on campus looking for amazing students to join their team as student employees. Billings is a large community full of economic opportunities for part-time work, internships, and volunteer experiences.

Student Organizations

We have a wide range of student organizations and clubs which include academics, arts, supportive services, student government, culture & religion, recreation, and more.



BE A LEADER

Leadership opportunities include running for an elected position within ASMSUB (student government), becoming a Resident Assistant (RA), becoming an executive member of the Residence Hall Association, attending leadership seminars and workshops, or working your way up to a student organization's leadership position.

STUDENT WELLNESS

We're here to help students thrive and succeed! We provide medical care, mental health counseling, and a wellness program to help you make the most of your time at MSUB. Students can utilize the Health Service just across from Petro Residence Hall Lobby and at City College in the Tech Building.

TUTORING AND MENTORING

Located in the Student Union Building and at City College in the Tech Building, you don't have to go outside to take advantage of our Academic Support Center. Get tutoring assistance to get you through a challenging course, take advantage of other workshops and resources, or just settle in to study.

HONORS

Our honors program provides intellectually stimulating classes and career building opportunities for those who apply. Honors Students receive special advising and mentorship throughout their education at MSU Billings.

RESIDENCE HALL ASSOCIATION (RHA)

RHA's main focus is social and educational programming for residents, providing ample opportunities for interaction and involvement.



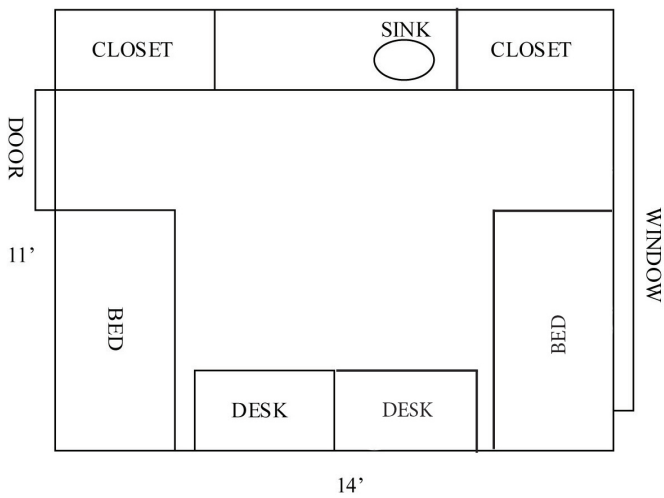
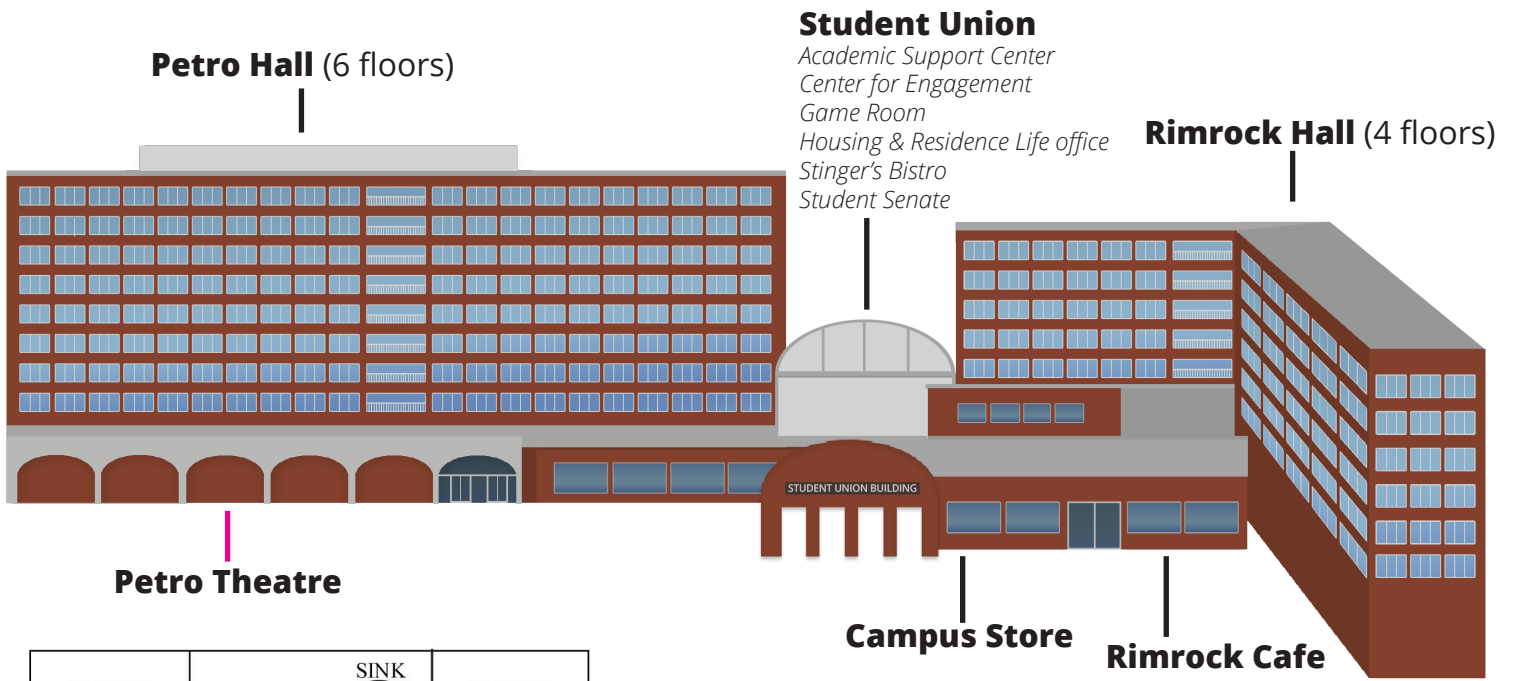

How much does living on campus cost?

Semester Rates for 2024 - 2025

Double room - \$2602 semester

Single room - \$3155 semester

Rimrock Hall and Petro Hall have very similar room styles that are 11 by 14 feet. Each room includes two desks, built in shelves, two closets, a sink with a counter and mirror, curtains, wireless & hard wired internet access, and two twin adjustable beds with bunking abilities. Petro has a dedicated workout space on the main floor. Rimrock and Petro hall have computer lab and printing access for students.

FLOOR COMMUNITIES

Floor themes are an exciting new addition to the MSUB residence halls. Student residents will be able to enjoy an active floor community committed to serving as an interest group to promote and facilitate learning opportunities and experiences which stem from the designated floor theme. The 2024-2025 academic year will see the implementation of the Health and Recreation Floor. The Health and Recreation floor, located on the 5th floor of Rimrock, is a theme where residents can experience activities and events related to intramural, outdoor recreation (hiking, camping, etc.), and health and wellness activities. This floor will be working with Health Services, Heroes and Outdoor Leadership.

Feel free to stop by the Housing & Residence Life Office for more information.



Petro Hall



Rimrock Hall



Student Union Building



Petro Hall

(6 floors)

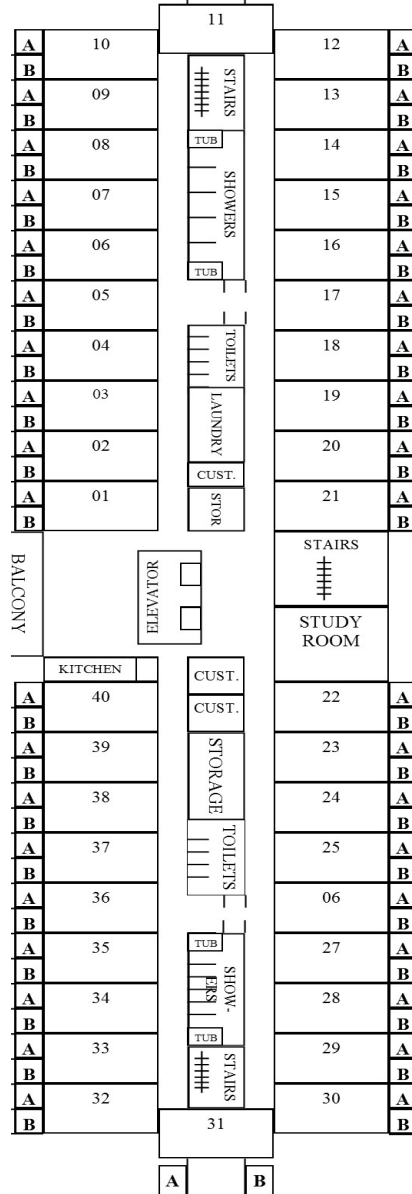

Rimrock Hall

(4 floors)

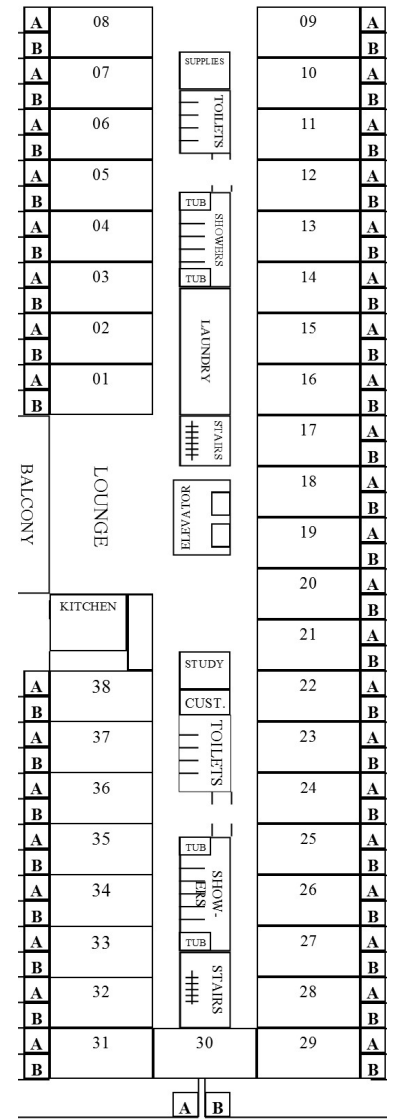

MEAL PLANS

COST PER SEMESTER 2024-2025 (Rates subject to change)

Stinger - \$2250

This plan provides 19 meals per week in our all-you-care-to-eat Rimrock Café plus \$50 in Dining Dollars.

Buzz - \$2250 Monday-Friday

This plan provides three meals per day, Monday through Friday in our all-you-care-to-eat Rimrock Café plus \$275 in Dining Dollars.

Hive - \$2100

This plan is a block meal plan, providing 160 meals per semester in our all-you-care-to-eat Rimrock Café plus \$300 in Dining Dollars.

Nest - \$2041

This plan is a block meal plan, providing 125 meals per semester in our all-you-care-to-eat Rimrock Café plus \$400 in Dining Dollars.

LIVING AND DINING

What is a Block Meal Plan?

A type of meal plan that gives you a set number of meals to eat within a given semester. Students must use meals within the semester and meals will not carry over to the next semester.

What is a Meals Per Week Plan?

A type of meal plan that provides a set number of meals within a week. Students must use the defined number of meals within the given week, and the meals will not carry over to another week. The Stinger and Buzz Monday-Friday meal plans are per week plans

What are Dining Dollars?

Money put on your U-Card to use for coffee and other grab-and-go items from any MSU Billings dining location on the University and City College campus. Your dining dollar balance will carry over from the Fall to Spring semester, but needs to be used by the end of Spring semester. Dining dollars are a part of all of our residence halls meal plans.

U-Card

Your U-Card is not only your university identification, but also your, library card, and more. Deposit money on your card to use around campus for printing, purchasing gear at the Campus Store, buying food and coffee at any of the campus food service locations, and vending machines. *Students will learn how to add money to their U-Card at orientation.*

City College Dining

At City College, dining is a-la-carte, and students can select from a variety of meal options. Students can still use a meal from their plan when they eat lunch at City College, rather than using dining dollars or paying in cash.

How do I know what meal plan is best for me?

Consider your current eating habits. Will you want three full meals per day, or will you want to grab a snack for some? Do you anticipate working in the evening? Dining Services is willing to provide a sack meal for students who might miss an evening meal. Just ask. You are given a short time to make changes to your meal plan when the semester starts & also for the spring semester.

Double and Single Rooms

Every room is built the same that means single rooms are the same size and include everything a double room does. Single rooms are assigned based on space and availability.

Social & ResNet Fees

Every semester, students pay a \$15 Social Fee and a \$75 ResNet Fee. The \$15 Social Fee goes into the programming budget for planned events during the academic year in the residence halls. The \$75 ResNet fee goes to continued support, maintenance, and improvements for our technology and Wi-Fi service in the residence halls.

Extended Stay Program

Need a room in the residence halls for a night, a week or longer? Extended Stay offers a new flexible option if rooms are available, especially for commuter students during the winter months. Spend a night (or more as you wish) in the residence halls. (Note: A meal plan is not required for this option.)

- Daily rate - \$36
- Weekly rate -\$220



For more information, contact the Office of Housing & Residence Life

(406) 657-2333

msubillings.edu/reslife

housing@msubillings.edu

Student Union Building, 225

Montana State University Billings | 1500 University Drive | Billings, Montana 59101-0245

Connect with us:



Montana State University Billings has a policy of nondiscrimination in employment practices and in admissions, access to and conduct of educational programs and activities pursuant to title VII of the Civil Rights Act, Title IX of the Education Amendments, Section 504 of the Rehabilitation Act, Executive Order 11246 as amended, Vietnam era and Disabled Veterans Act, as amended, and the Montana State Human Rights Act. Any person with disabilities concerned about accessibility and/or accommodation issues should contact Disability Support Services (406) 657-2283.

To access the annual campus crime report, please visit: msubillings.edu/security
To access consumer information visit: msubillings.edu/finaid/Consumer_Information.htm