

### 3RD FLOOR BEAM SCHEDULE

MARK	SPAN	LENGTH	NO. OF BEAMS	SECTION	TYPE
3B.1	12	18	7	TOP STR	5.5
3B.2	12	16	7	TOP STR	5.5
				3' @ 18' PER LENGTH	5.5
				3' @ 18' PER LENGTH	5.5

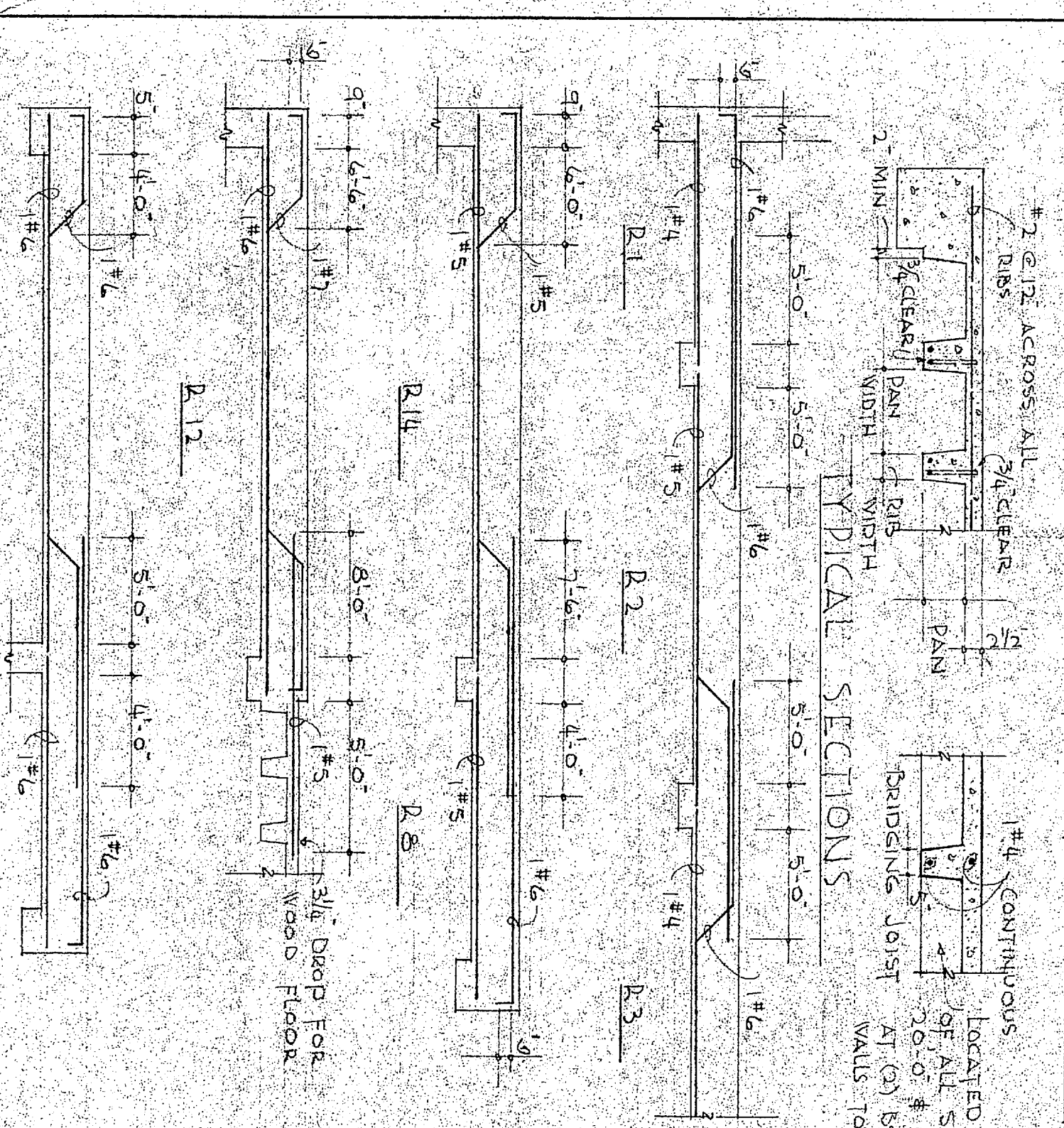

R.I.B. DETAILS  
NO SCALE

### R.I.B. SCHEDULE

MARK	SPAN	DEPTH	REINFORCING	TOP STR.
R.1	12	20	14#	14#
R.2	12	20	14#	14#
R.3	12	20	14#	14#
R.4	12	20	14#	14#
R.5	12	20	14#	14#
R.6	12	20	14#	14#
R.7	12	20	14#	14#
R.8	12	20	14#	14#
R.9	12	20	14#	14#
R.10	12	20	14#	14#
R.11	12	20	14#	14#
R.12	12	20	14#	14#
R.13	12	20	14#	14#
R.14	12	20	14#	14#
R.15	12	20	14#	14#
R.16	12	20	14#	14#
R.17	12	20	14#	14#
R.18	12	20	14#	14#
R.19	12	20	14#	14#
R.20	12	20	14#	14#

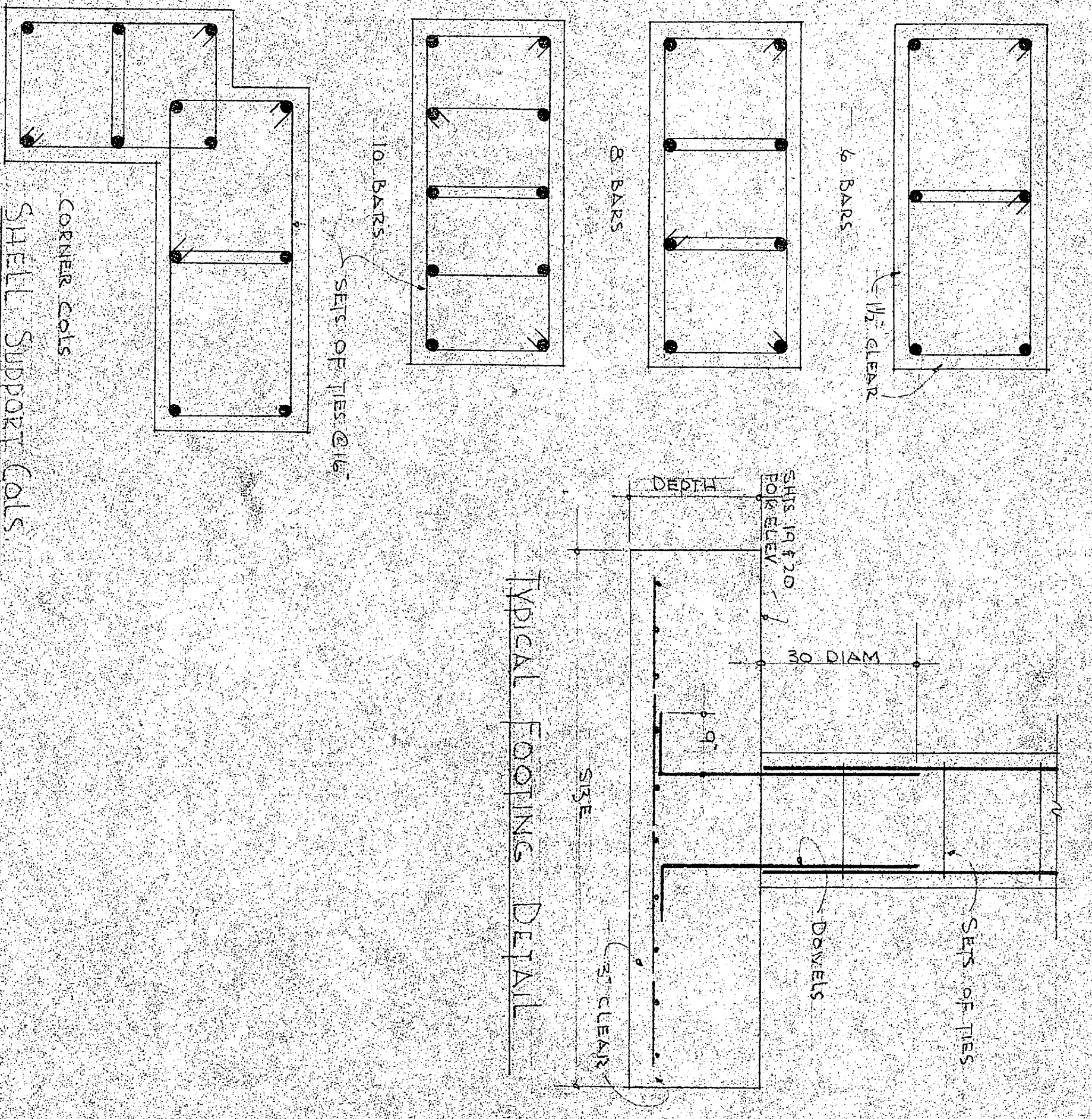

### STEEL LINTEL SCHEDULE

MARK	DETAIL	WALL THICKNESS	LENGTH	LOCATION
L-1	A	8"	3'-5"	DOOR 2010/2015
L-2	B	8"	3'-5"	DOOR 2010/2015
L-3	C	8"	4'-0"	DOOR 2010/2015
L-4	D	8"	4'-0"	DOOR 2010/2015
L-5	E	8"	4'-0"	DOOR 2010/2015
L-6	F	8"	4'-0"	DOOR 2010/2015
L-7	G	8"	4'-0"	DOOR 2010/2015
L-8	H	8"	4'-0"	DOOR 2010/2015
L-9	I	8"	4'-0"	DOOR 2010/2015
L-10	J	8"	4'-0"	DOOR 2010/2015
L-11	K	8"	4'-0"	DOOR 2010/2015
L-12	L	8"	4'-0"	DOOR 2010/2015
L-13	M	8"	4'-0"	DOOR 2010/2015
L-14	N	8"	4'-0"	DOOR 2010/2015
L-15	O	8"	4'-0"	DOOR 2010/2015
L-16	P	8"	4'-0"	DOOR 2010/2015
L-17	Q	8"	4'-0"	DOOR 2010/2015
L-18	R	8"	4'-0"	DOOR 2010/2015
L-19	S	8"	4'-0"	DOOR 2010/2015
L-20	T	8"	4'-0"	DOOR 2010/2015
L-21	U	8"	4'-0"	DOOR 2010/2015
L-22	V	8"	4'-0"	DOOR 2010/2015
L-23	W	8"	4'-0"	DOOR 2010/2015

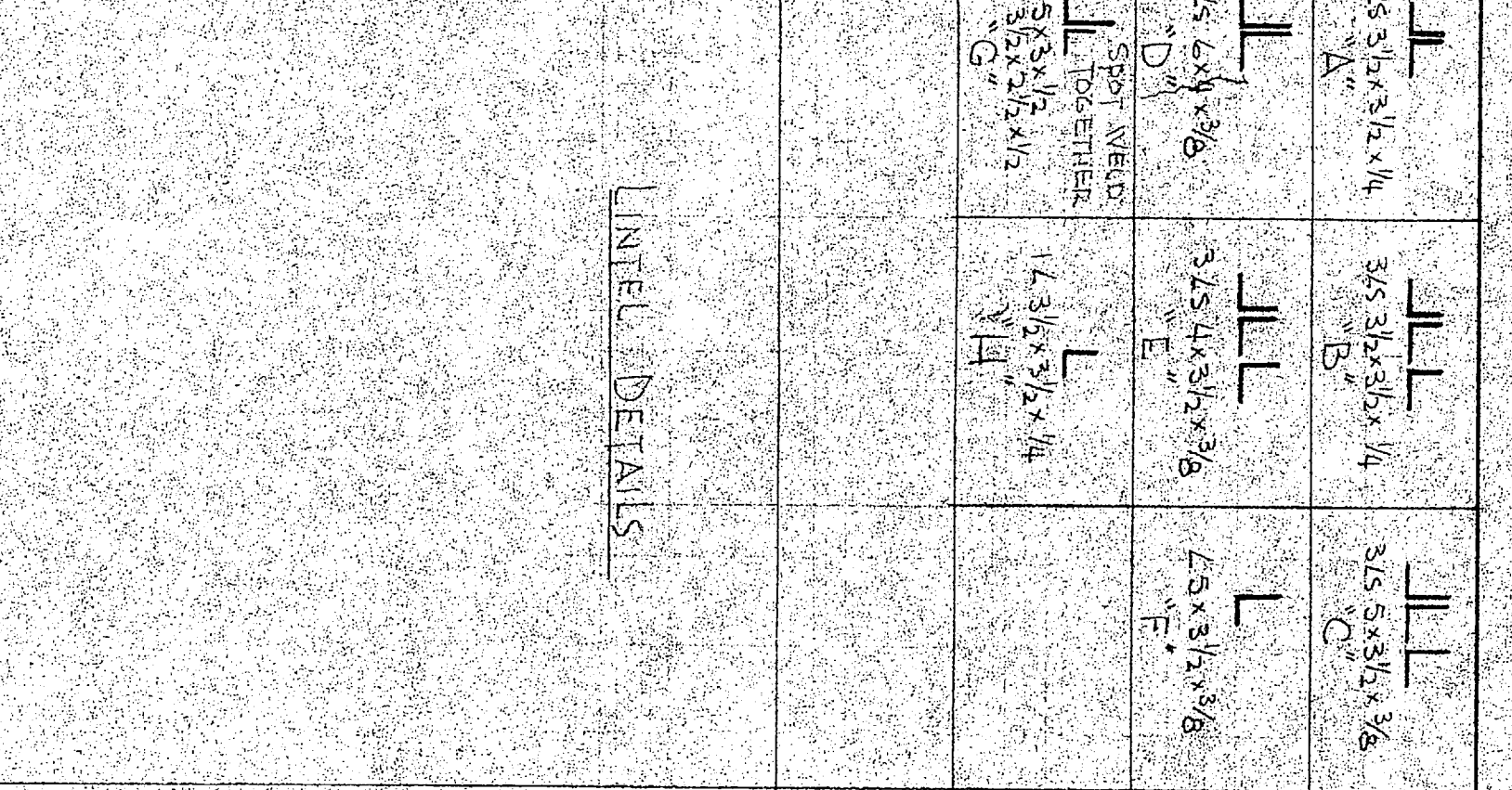

3RD FLOOR FRAMING PLAN

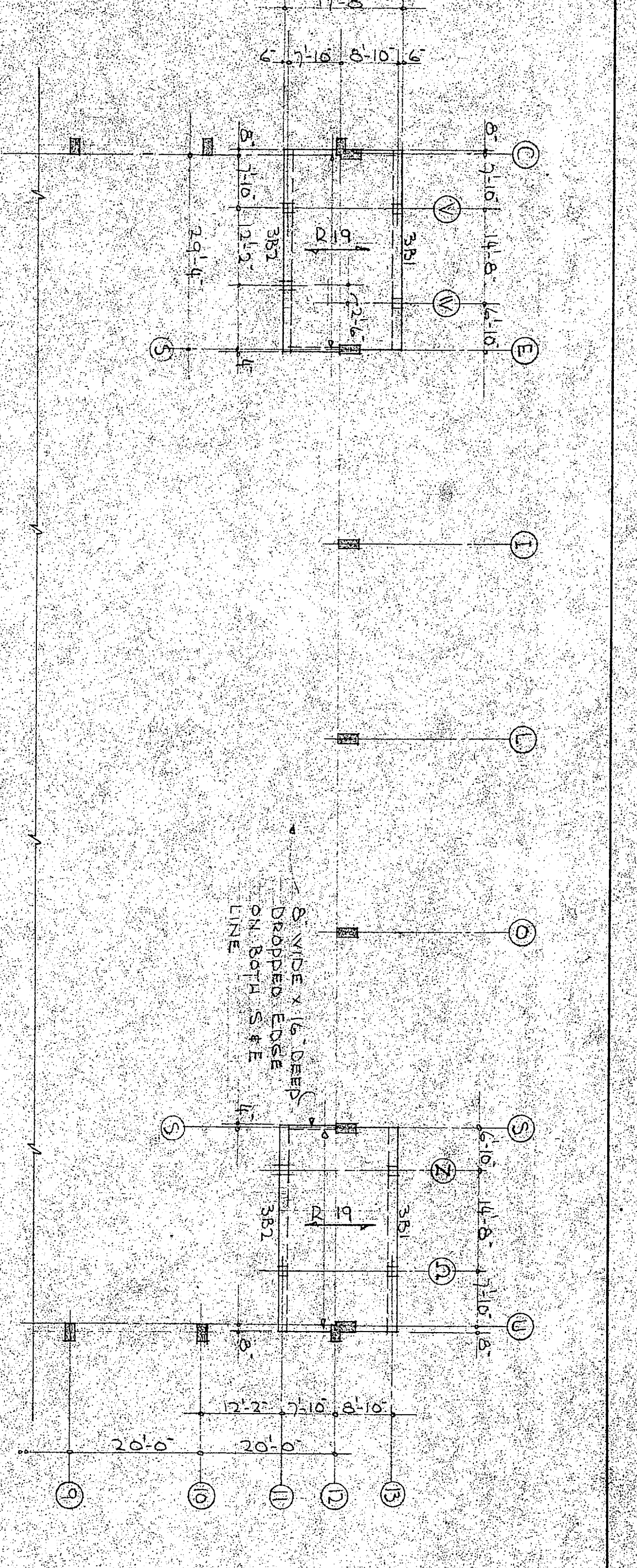

### FOOTINGS SCHEDULE

MARK	NO.	SIZE	DEPTH	REINFORCING	TYPE
F.1	1	12' x 12'	12"	14#	ISOLATED
F.2	2	12' x 12'	12"	14#	ISOLATED
F.3	3	12' x 12'	12"	14#	ISOLATED
F.4	4	12' x 12'	12"	14#	ISOLATED
F.5	5	12' x 12'	12"	14#	ISOLATED
F.6	6	12' x 12'	12"	14#	ISOLATED
F.7	7	12' x 12'	12"	14#	ISOLATED
F.8	8	12' x 12'	12"	14#	ISOLATED
F.9	9	12' x 12'	12"	14#	ISOLATED
F.10	10	12' x 12'	12"	14#	ISOLATED
F.11	11	12' x 12'	12"	14#	ISOLATED
F.12	12	12' x 12'	12"	14#	ISOLATED
F.13	13	12' x 12'	12"	14#	ISOLATED
F.14	14	12' x 12'	12"	14#	ISOLATED
F.15	15	12' x 12'	12"	14#	ISOLATED
F.16	16	12' x 12'	12"	14#	ISOLATED
F.17	17	12' x 12'	12"	14#	ISOLATED
F.18	18	12' x 12'	12"	14#	ISOLATED
F.19	19	12' x 12'	12"	14#	ISOLATED
F.20	20	12' x 12'	12"	14#	ISOLATED

COLUMN SCHEDULE

MARK	NO. OF COLS	SECTION	TYPE
C.1	1	12' x 12'	ISOLATED
C.2	2	12' x 12'	ISOLATED
C.3	3	12' x 12'	ISOLATED
C.4	4	12' x 12'	ISOLATED
C.5	5	12' x 12'	ISOLATED
C.6	6	12' x 12'	ISOLATED
C.7	7	12' x 12'	ISOLATED
C.8	8	12' x 12'	ISOLATED
C.9	9	12' x 12'	ISOLATED
C.10	10	12' x 12'	ISOLATED
C.11	11	12' x 12'	ISOLATED
C.12	12	12' x 12'	ISOLATED
C.13	13	12' x 12'	ISOLATED
C.14	14	12' x 12'	ISOLATED
C.15	15	12' x 12'	ISOLATED
C.16	16	12' x 12'	ISOLATED
C.17	17	12' x 12'	ISOLATED
C.18	18	12' x 12'	ISOLATED
C.19	19	12' x 12'	ISOLATED
C.20	20	12' x 12'	ISOLATED

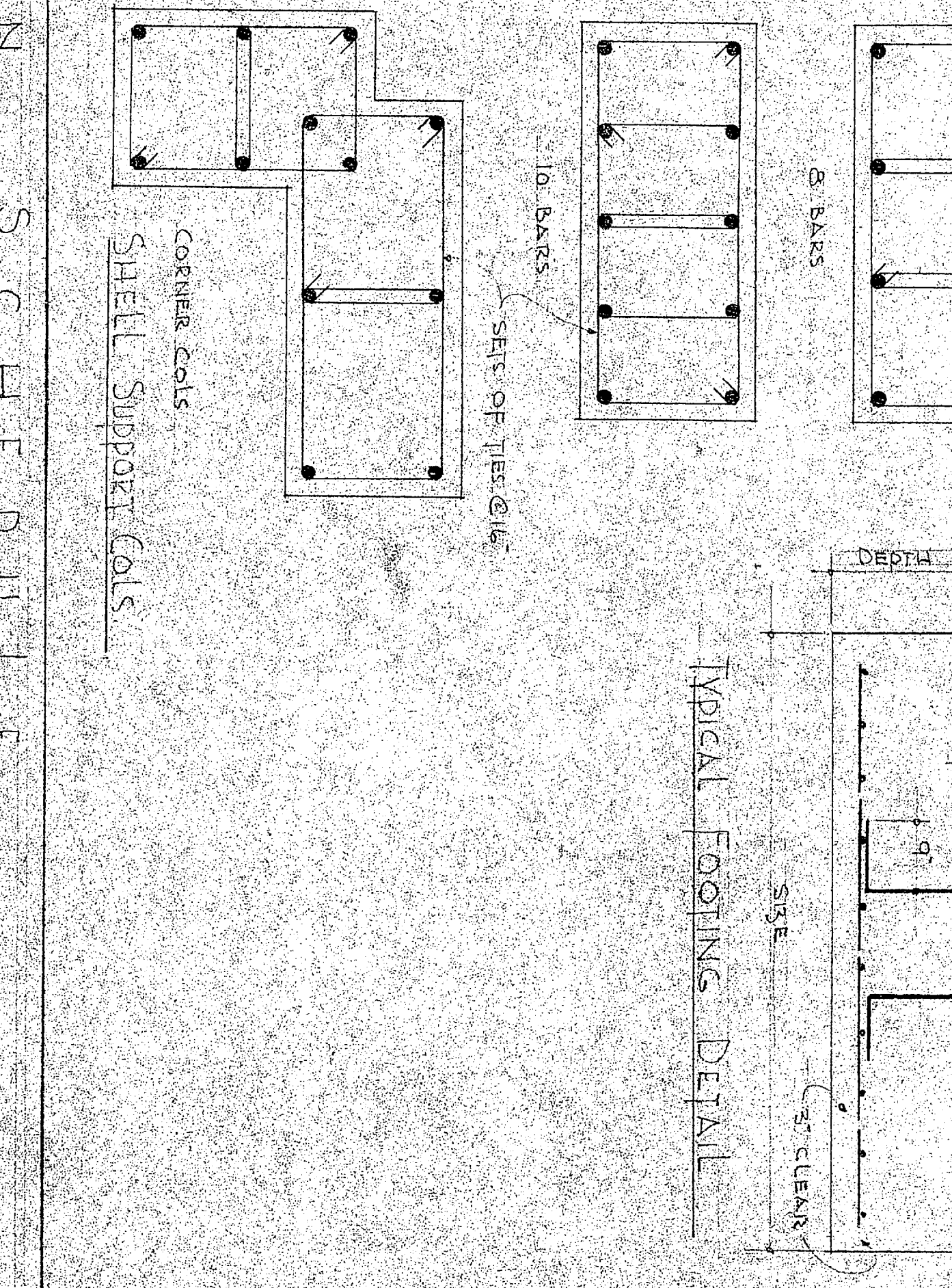

### NOTES

- ALL COLUMNS, EXTEND TO MORE THAN 1/2" BELOW BASEMENT FLOOR LINE. SPICE COL STEEL AT BOTTOM OF WALL AT PERIMETER COLUMNS & AT BENT LINE AT INTERIOR COLS.
- NOTE: REBAR IN COL SUPPORTING STEEL, ACCORDANCE WITH ACI DESIGN MANUAL.
- SPICE COLS AT FLOOR LINE IN GENERAL (EXCEPT IN 3RD FLOOR LINE WHERE NO NUMBERED REBAR IN).
- SEE SHEET 19.00 FOR ELEV OF TOP OF FOOTINGS.

PHYSICAL EDUCATION BUILDING  
EASTERN MONTANA COLLEGE OF EDUCATION  
Billings, Montana

cutting, detailing, and construction documents  
ASSOCIATED ARCHITECTS  
BILLINGS, MONTANA

STATE OF MONTANA  
REGISTERED ARCHITECT  
No. 1000  
JAMES A. COLE

DATE: 10/1/58  
DRAWN BY: JAC  
CHECKED BY: JAC